

White Ink Change

User Operation Quick Guide



Please be sure to read this document before switching from the current white ink (W0) to the new white ink (W1).

If you have any questions, please contact your local dealer.

Failure to follow the procedures in this document may result in improper operation.

1 Getting Started

1-1 Software Download for Updates

Please download the firmware, printer driver, and Graphics Lab from the support website. Scan the QR code below to access the support site for your region.

Americas (North, Central & South), Asia and Oceania



Europe, Middle East & Africa



Japan



China



Access the support website and download the update file corresponding to your printer model. For details on the supported versions, refer to Section 1-2.

1-2 Update Software Version Information

Please refer to the version information below, download the update file corresponding to your printer, and perform the update.

Printer	Ink	Firmware	Driver	Graphics Lab
GTX422	GC40W01-700	4.00	4.0.0	9.0.0
GTXpro (GTX423)	GC40W01-700	5.00	5.0.0	
GTXproB (GTX424)	GC40W01-02K GC40W01-18L			
GTXpro R2R (GTX423-Roll)	GC40W01-700	5.00	5.0.0	
GTXproB R2R (GTX424-Roll)	GC40W01-02K GC40W01-18L			
GTX600NB	GC60W01-09L GC60W01-18L	4.00	4.0.0	
GTX600SB	GC60W01-09L GC60W01-18L	4.00	4.0.0	

1-3 Precautions for Updating

Firmware

The W1 ink uses a new IC chip; therefore, it cannot be used if the firmware is not up to date. In addition, since W1 ink cannot be distinguished from W0 ink by appearance, please check the label on the pouch to identify the ink type.

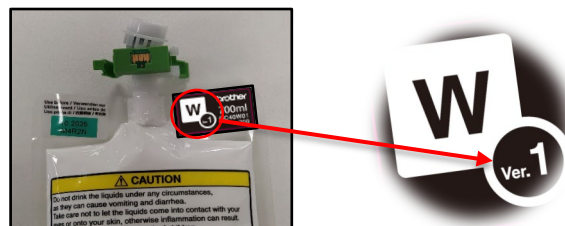

Printer Driver / Graphics Lab

By updating the printer driver and Graphics Lab to the latest versions, you will be able to use color profiles compatible with W1 ink. After the update, a parameter called “White ink Ver.” will be added to the print settings window during output.

2 Switching to W1 Ink

2-1 Overview of W1 Ink

- W0 ink and W1 ink can be used when mixed. After W0 ink is used up, continue using the printer by replenishing W1 ink.
- Storage conditions: Same as before.
- Expiration date: Same as before.

2-2 Pouch Model Switching Procedure

When the W12 and W34 white ink pouches are depleted, replace them with W1 ink pouches and continue normal operation.

By using two W1 ink pouches for each of W12 and W34, the W0 ink remaining in the machine will be completely purged.

2-3 Bottle Model Switching Procedure

After the “Empty” message is displayed on the printer’s operation panel, refill W1 ink up to the Full line and continue normal operation.

By repeating the above refill procedure four times, the W0 ink remaining in the machine will be completely purged.

3 Printing Related

3-1 Print Settings

When outputting print data to the printer, set “White Ink Ver.” in the print settings window according to the white ink being used.

- “1” : When using W1 ink (select “1” once W1 ink has been refilled)
- “0” : When using W0 ink

If the color profile settings are not configured correctly, print quality may be affected. If there is an issue with print quality, please refer to “3-5 Print Quality Troubleshooting Flow” and review the settings.

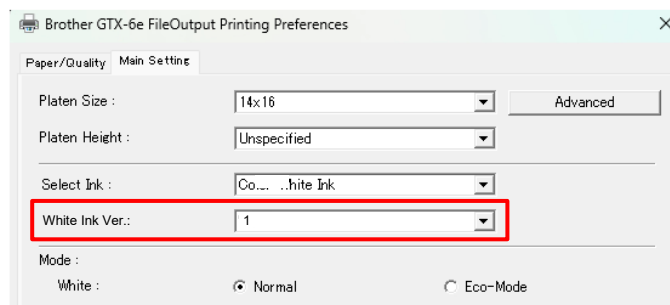

3-2 Procedure for Checking the Color Profile Version

The color profile version set in the print file can be checked using the following procedure:

1. Double-click the *.arxx file to open it.
2. Check the “White Ink Ver.” item in the displayed window.

Be sure to verify the color profile version before printing to avoid any errors.

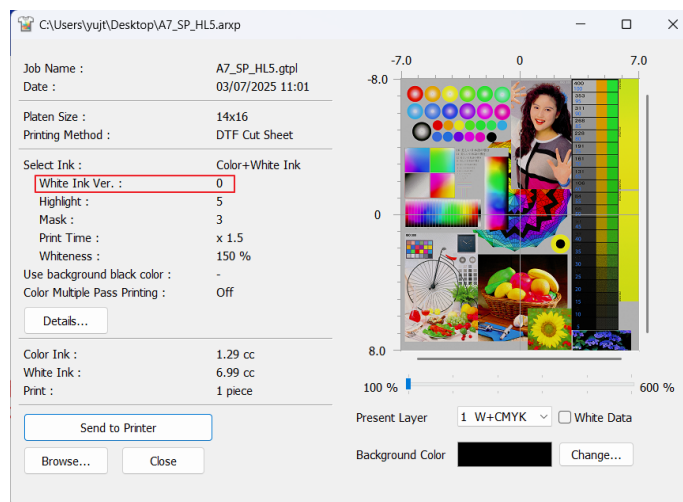

3-3 Precautions for Printing

Due to the characteristics of W1 ink, bleeding may occur depending on the conditions; however, this can be improved by adjusting the highlight settings in Graphics Lab.

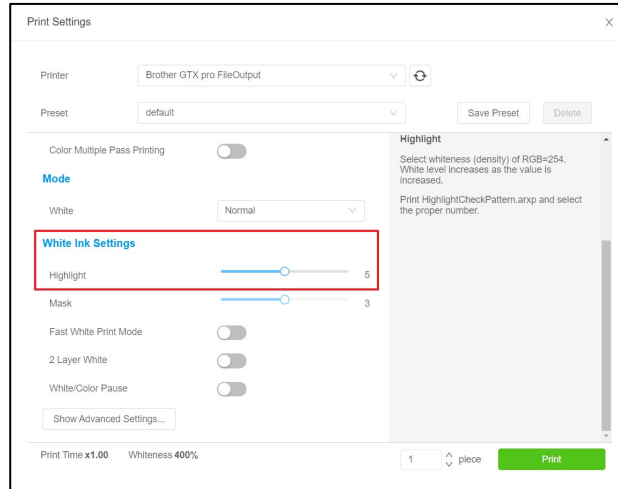

3-4 Recommended Drying Conditions

Due to differences in the drying characteristics of W1 ink, some changes have been made from the conventional recommended conditions. For details, please contact your local dealer.

3-5 Print Quality Troubleshooting Flow

If reduced white density or bleeding occurs during printing, please follow the flowchart below to check the settings and conditions. If the issue persists, please contact your local dealer.

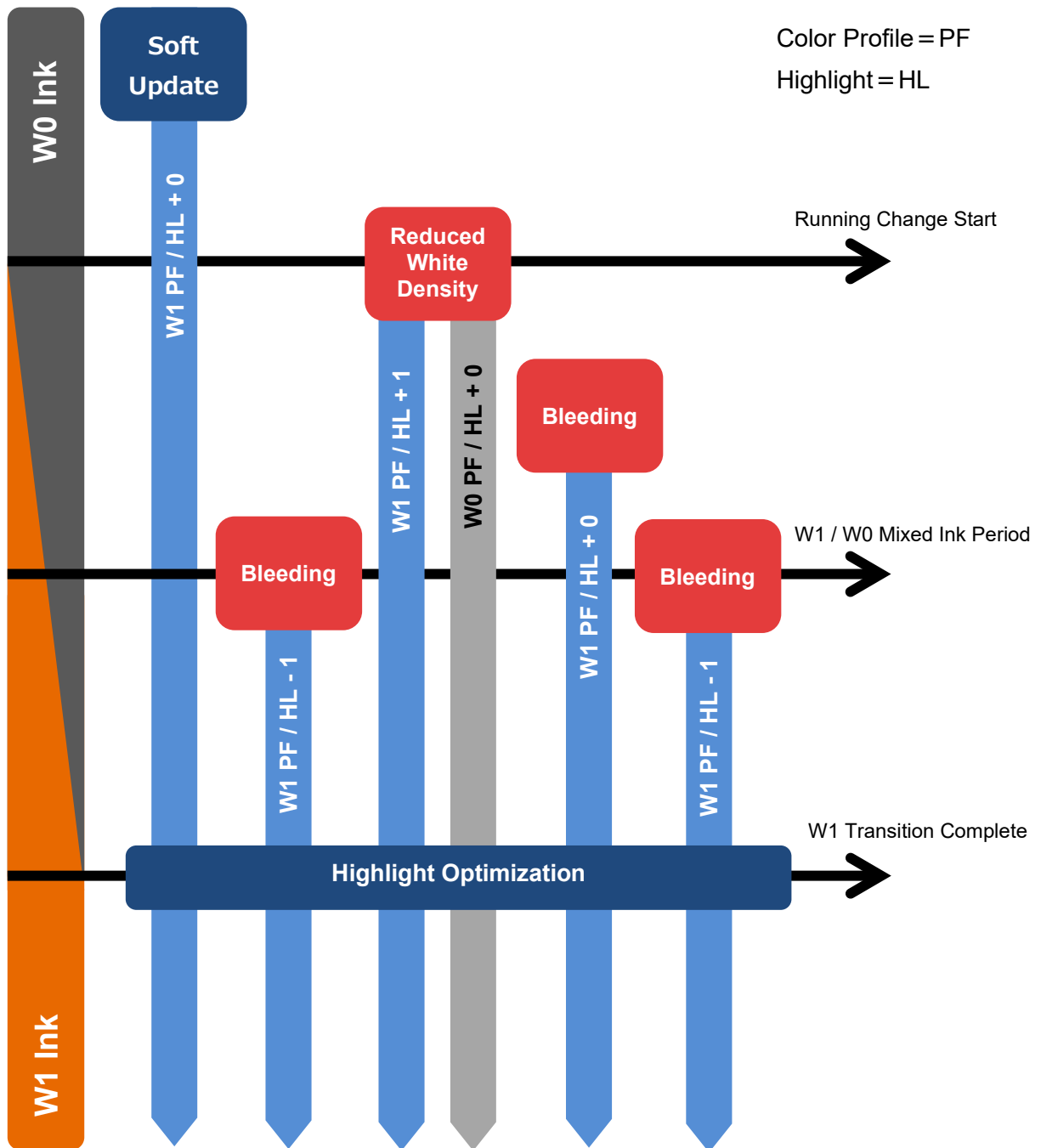

4 Maintenance Related



4-1 Change in Wiper Cleaner Replacement Interval Period

With the transition to W1 ink, the replacement timing may be earlier depending on the customer's usage conditions.

5 FAQ

No.	Question	Solution
1	Can W0 ink still be used after the software update?	W0 ink can still be used after the software update.
2	When the software is updated while using W0 ink, which setting should be selected for “White Ink Ver.,” “0” or “1”?	After updating the software, please select “1” in principle.
3	Does mixing W0 ink and W1 ink affect the printer or print quality?	There is no impact on the printer itself; however, print quality may temporarily vary until the ink is fully replaced with W1 ink. After that, it will stabilize. For details, please contact your local dealer.
4	We are using a 3rd-party RIP. How can we optimize print settings for W1 ink in the RIP?	For details, please contact your local dealer.
5	Are there any improvements in W1 ink compared to W0 ink?	W1 ink is compliant with environmental certifications; it is not a change intended to improve print quality.
6	How can W1 ink be distinguished from W0 ink?	There is no difference in the liquid color. However, the pouch/bottle design and packaging have been changed, and “Ver.1” is indicated on the label.
7	The ink is not recognized. What should I do?	Please update the firmware to the latest version.
8	Bleeding occurs. What should I do?	Check whether the “White Ink Ver.” setting is correct. Bleeding may also be improved by adjusting the highlight settings in Graphics Lab.
9	Can print data created for W0 ink still be used after switching to W1 ink?	Yes, it can be used; however, bleeding may occur depending on the conditions.
10	Will W0 ink still be available for purchase?	No. W0 ink has been discontinued, and only W1 ink is available.
11	What is the shelf life of W1 ink?	It is the same as W0 ink.
12	Is it necessary to change pretreatment settings when switching to W1 ink?	Basically, no changes are required.
13	For pouch models, can the switching be done by replacing only one white ink pouch, or is it necessary to replace two at the same time?	Replace the pouches one by one as each becomes empty.
14	If using an API, what changes are required?	The command-line tools also need to be updated to the latest version.
15	If multiple printers are in use, is it necessary to update all of them at once?	It is not necessary to update all units at the same time. For details, please contact your local dealer.

brother

www.brother.co.jp

ブラザー工業株式会社

BROTHER INDUSTRIES, LTD.